



5/24/2006

VISIT THE LIFETIME WEB SITE:
WWW.LIFETIME.COM

**** Do Not Contact the Store ****
For Assistance, including missing or broken parts,
Call Customer Service at:
1 (800) 225-3865

30" Wall Panel with Window for 8' Sheds
MODEL #0120

ASSEMBLY
INSTRUCTIONS AND
OWNER'S MANUAL

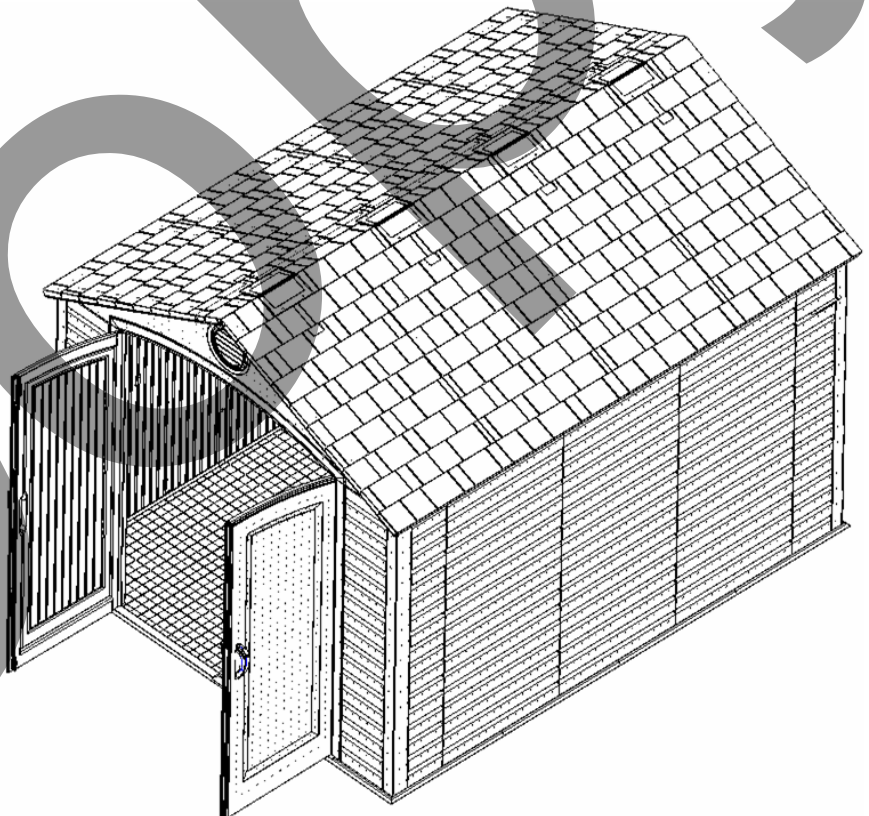

Save this instruction in the event that the manufacturer has to be contacted for replacement parts.

INSTRUCTION #1014033

****A MINIMUM OF TWO ADULTS ARE REQUIRED FOR ASSEMBLY****

STOP!

BEFORE BEGINNING ASSEMBLY

STOP!

Identify and inventory all parts using the checklist boxes on the Parts List. Keep the hardware bags and their contents separate. If any parts are missing, call our Customer Service Department.



SAFETY INSTRUCTIONS



Failure to follow these safety instructions may result in serious injury or property damage. Proper and complete assembly, use and supervision is essential for proper operation and to reduce the risk of accident or injury. A high probability of serious injury exists if this display is not installed, maintained, or operated properly. • If using a ladder during assembly, use extreme caution. Follow all warnings and cautions on the ladder carefully. • 2 people are required for assembly. • Misuse could result in system failure. • If technical assistance is required, contact the manufacturer.
Most injuries are caused by misuse and/or failure to follow instructions.

Parts List

ID	Part #	Description	Qty
WA	ZS12582	Wall Panel	1
WB	ZS01200	Window	1
Hardware Bag [1013715]			
TA	1007360	Window Latch	2
TB	BS07500	.25" x .625" Screw	17
TC	BS06100	#10 x 3/8" Pan Head Screw	1

HARDWARE IS ACTUAL SIZE

(unless otherwise indicated)

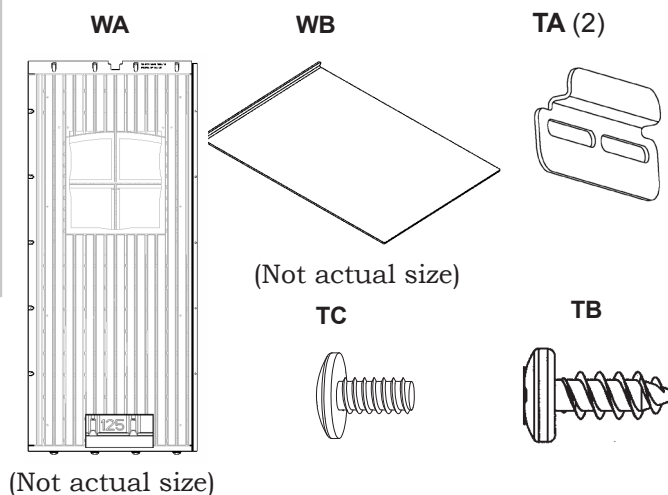

Tools and Materials Required for Assembly (Not Included)

1. #2 Phillips screwdriver or Electric drill with phillips head

If You are Installing a New Shed

1. Check contents of boxes and compare to parts listed on the Parts List.
2. Follow instructions that came with your shed, but replace the wall panel that came with this kit with the unwanted wall panel that came with your shed.

If You are Modifying an Existing Shed

1. Remove any objects from back shelves.
2. Remove any shelves, pegboards, or other objects hanging on the last two Side Wall Panels on either side.
3. Check contents of boxes and compare to parts listed on the Parts List.
4. Follow the steps in this manual.
5. If you are extending an 8' x 5' shed you will need to modify the following instructions by not removing as many parts as shown in the illustrations.

Note: You have the option to add the window wall panel to an existing shed or the option to insert the window wall panel in place of a regular wall panel on a new shed. Regardless of the option you take, you must attach the window to the panel. After attaching the window, you can proceed to the option that suits your needs.

Assemble Window

1 Remove plastic sheeting from **Window (WB)** and slide Window into slot on the **Window Wall Panel (WA)**. Attach a **Window Latch (TA)** above each corner of the Window as shown. When tightening **Screws (TB)**, be sure that Window Latches will slide freely. Do not overtighten. Insert **Screw (TC)** into the hole in the window. Set panel aside.

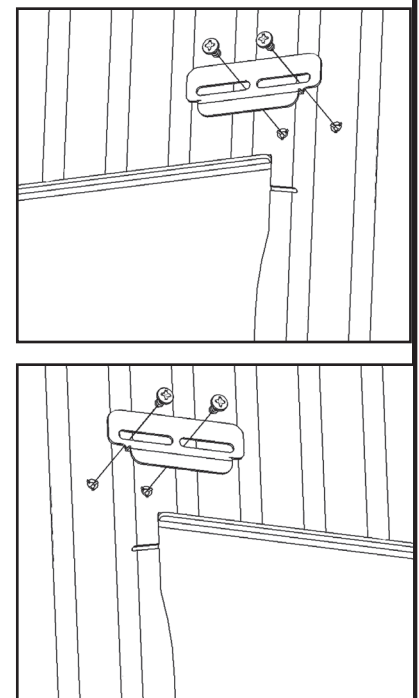
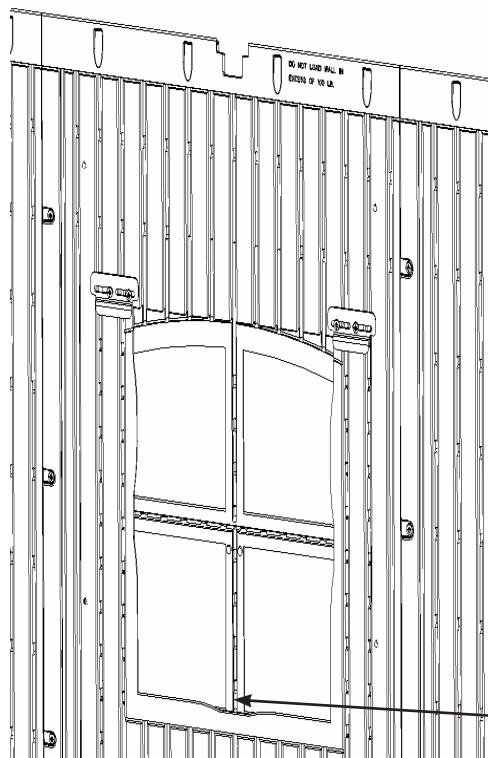
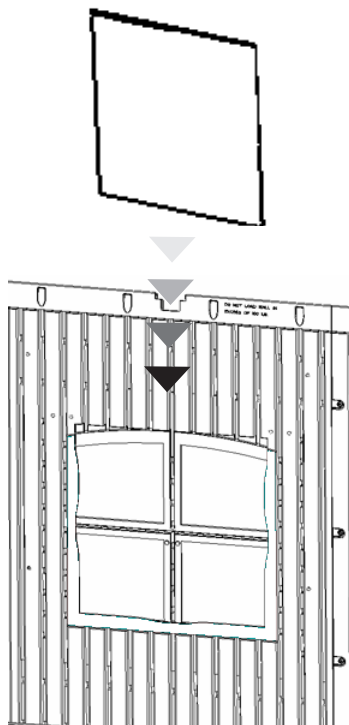
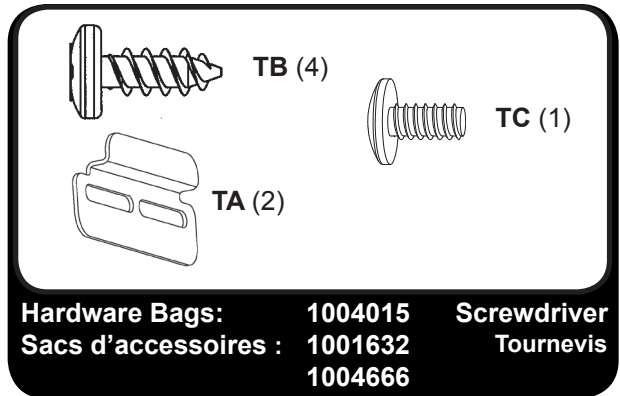

Place Screw (TC) in this hole to keep window from sliding up too far. Insert until flush with the window.



Insert window with bent edge at top and pointing away from the wall.

Option 1: Add Window Wall Panel to Existing Shed

****Save all hardware for re-assembly!****

Note: Keeping hardware separated according to where it came from will make reassembly easier.

- Q1** a. Remove last three **Skylights**. Save and set aside with hardware.

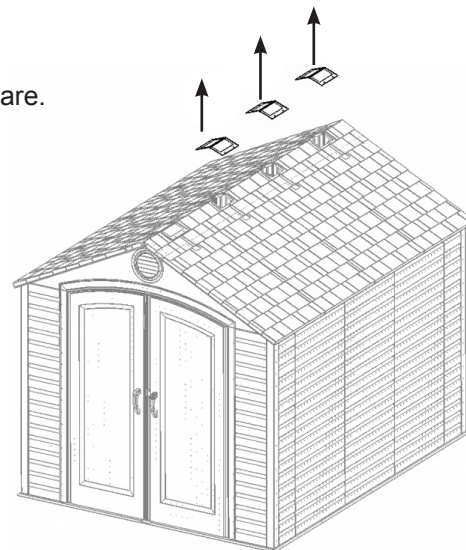

- Q2** a. Remove the last three **Roof Caps**. Save and set aside with hardware.

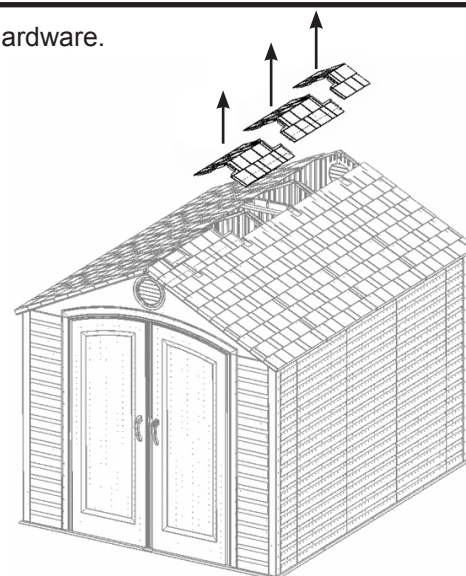

- Q3** a. Remove the back **Roof Panels** and **Roof Support Bars**. Save and set aside with hardware.

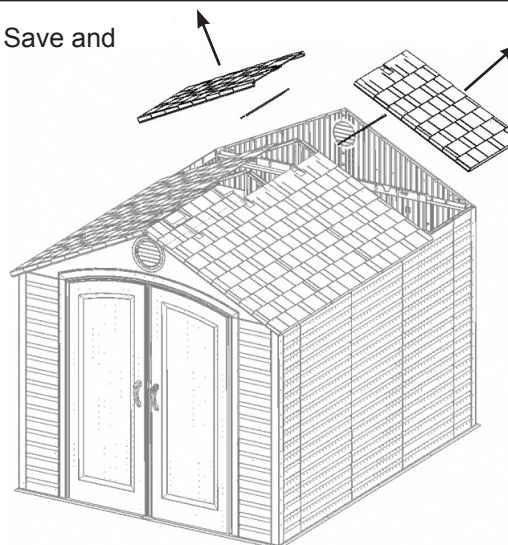

- O4** a. Remove the next **Roof panels** and **Roof support bars**. Save and set aside with hardware.

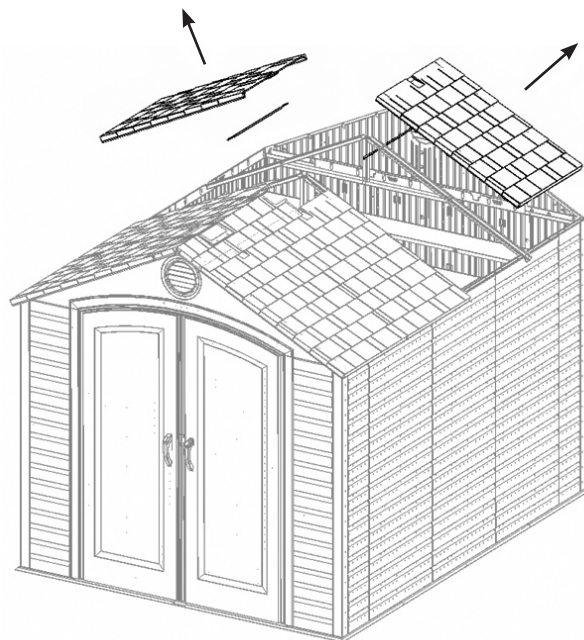

- O5** a. Remove the **Roof Truss**. Save and set aside with hardware.

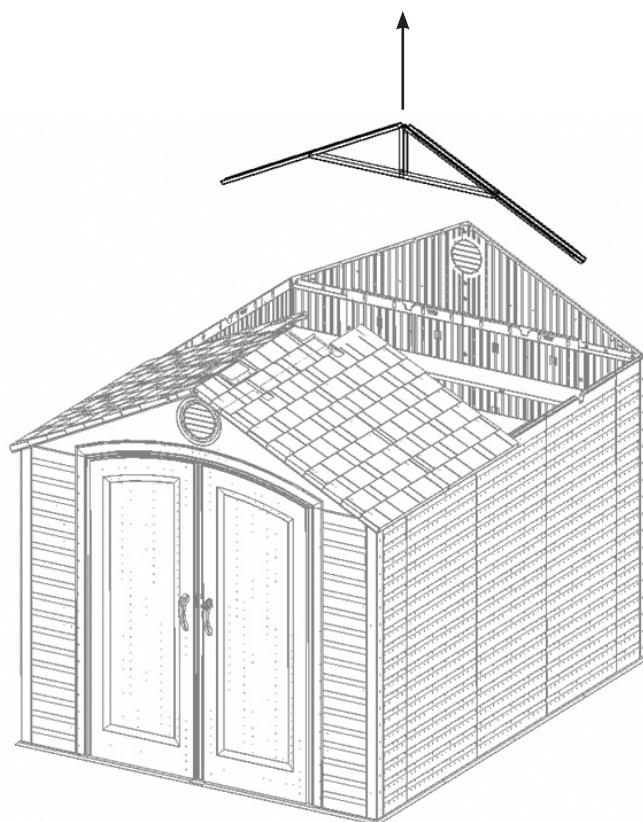

- Q6** a. Remove unwanted **Wall Panel**. Your wall panel may be different than the one shown.

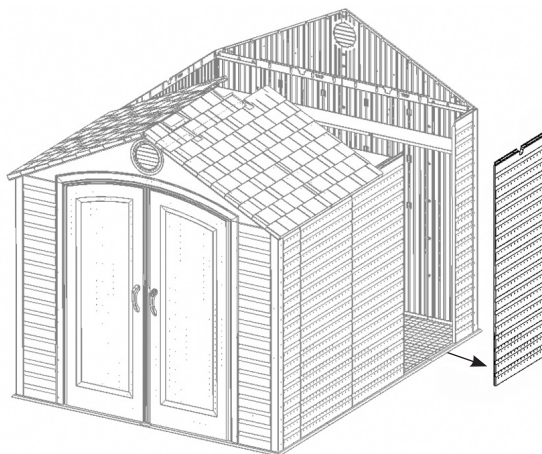

- Q7** a. Insert the new **Window Wall Panel (WA)** in place of the wall panel you removed and attach with **.25" x .625" Screws (TB)**. If you have not yet attached the window to the wall panel, refer to the section Assemble Window on page 3 for instructions.

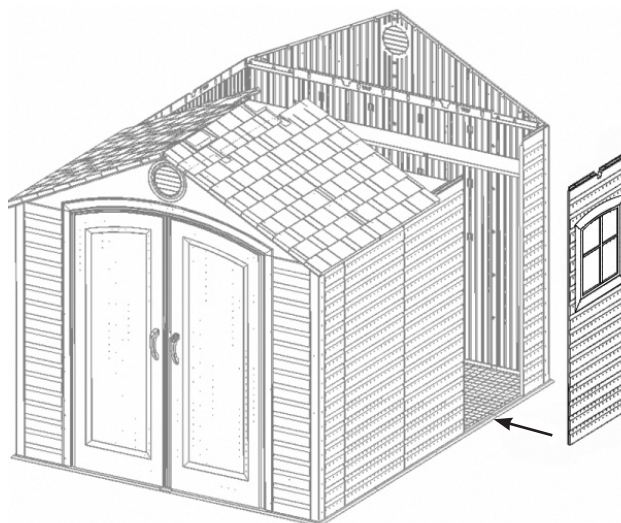

- Q8** a. Replace the **Roof Truss**.

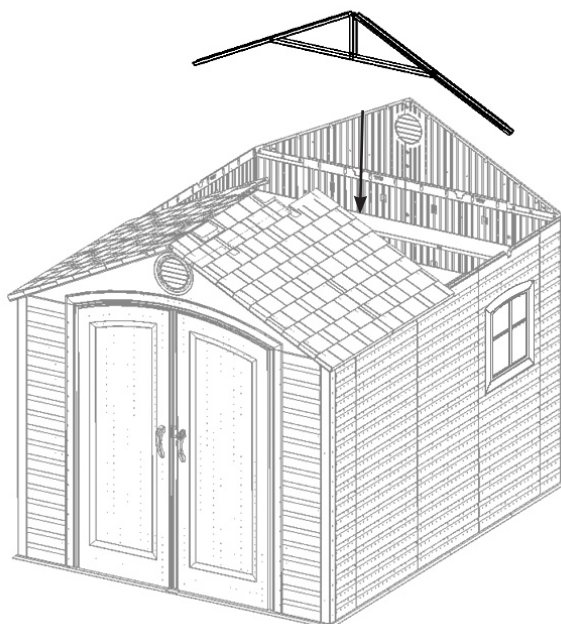

- O9** a. Replace the **Roof Panels** and **Roof Support Bars**.

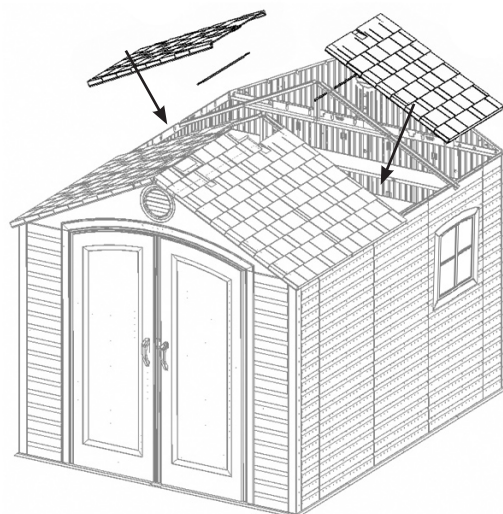

-
- O10** a. Replace the back **Roof Panels** and **Roof Support Bars**.

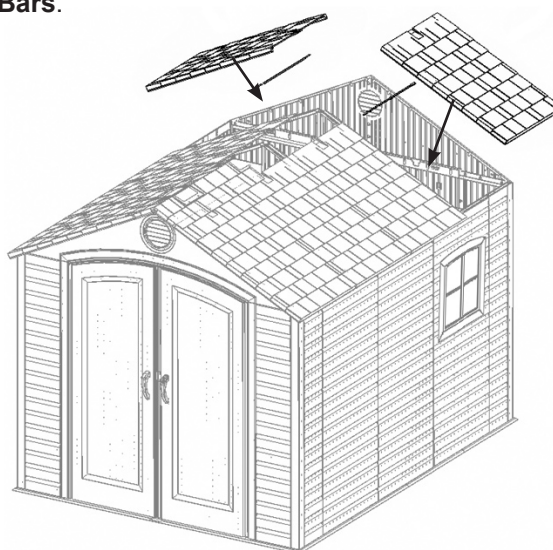

-
- O11** a. Replace the last three **Roof Caps**.

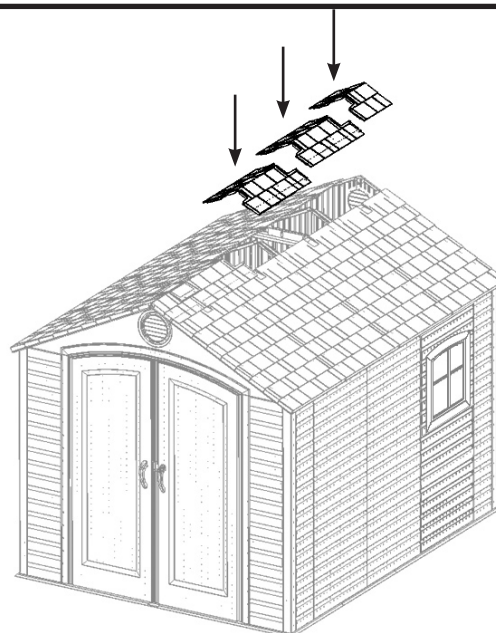

O12 a. Replace last three **Skylights**.

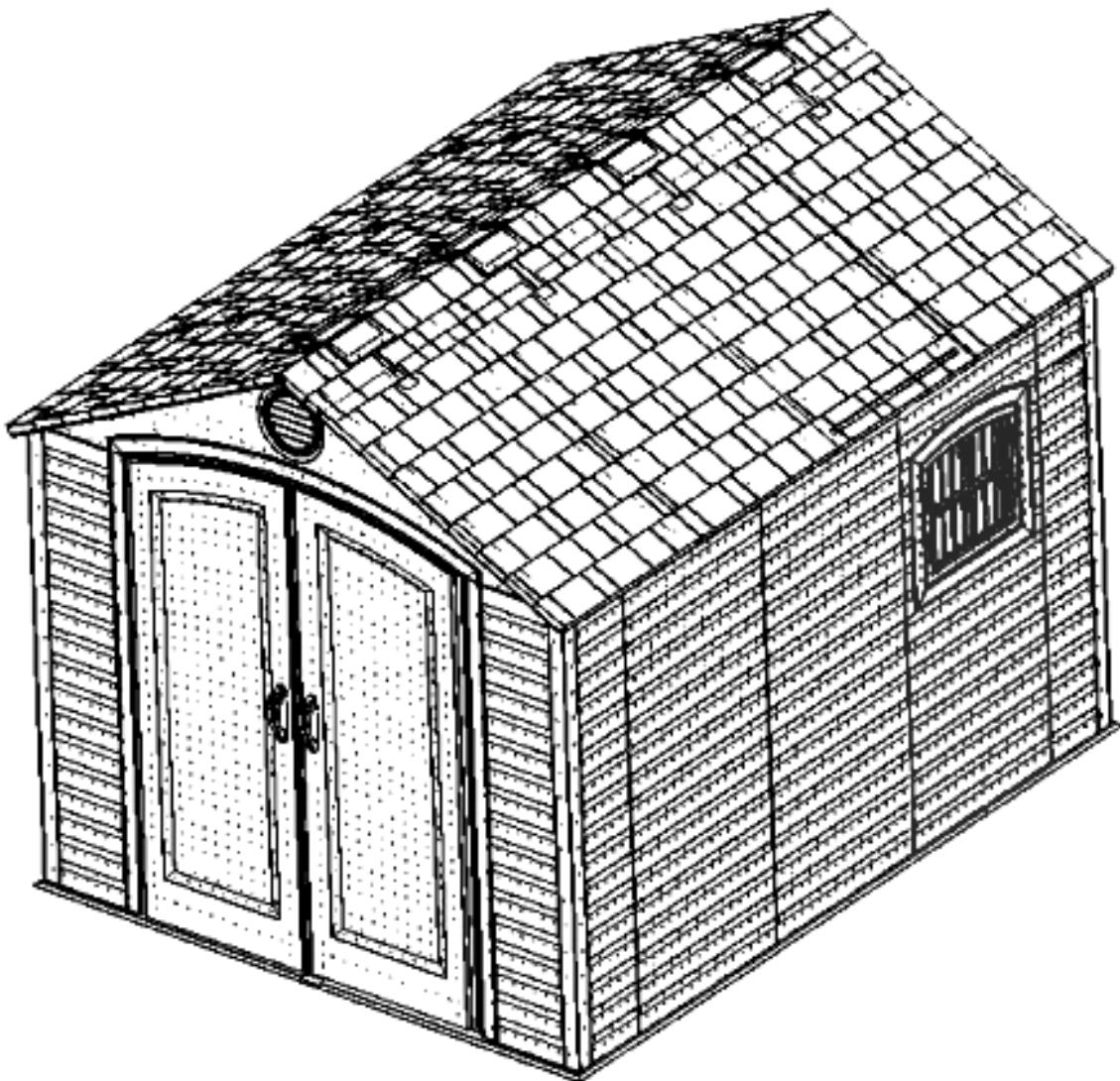
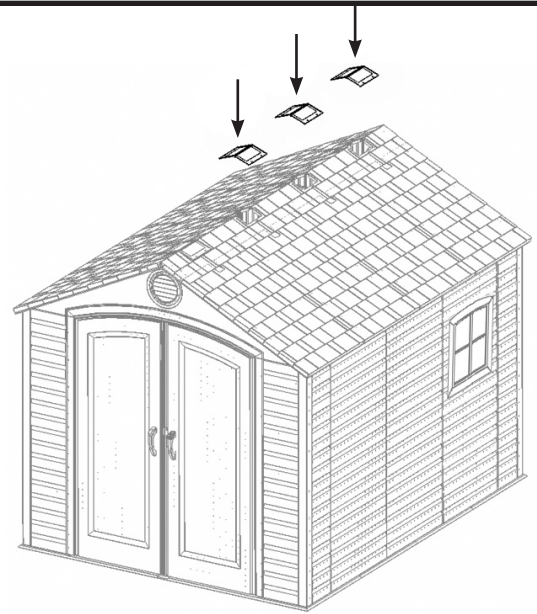

Option 2: Add Window Wall Panel to New Shed

To add the Window Wall Panel to a new 8' shed, simply insert the window wall panel in place of one of the regular wall panels. Refer to the assembly instructions in the Owners Manual for assistance.

Enhance your Lifetime® Outdoor Shed by purchasing the following Shed Accessories:

Model #

0110 Corner Shelf (2 pack)

Two 10" radius shelves with hardware.

0130 32" Shelf Kit w/ hardware (3 pack)

Three 32" x 10" Steel-Reinforced Shelves with shelf brackets and hardware.

0150 8' Shelf Kit w/ hardware

One 96" x 9" Steel-Reinforced Shelf with shelf bracket and hardware.

0170 Pegboard w/ hardware

One 22.5" x 22.5" Pegboard Panel with hooks. Great for hanging large and small items such as: rakes, shovels, and hand tools.

0190 Shelf Support Channel

Two Shelf Support Channels that allow the 32" shelves on either of the side walls of your shed.



0110



0130



0150



0170

***To purchase shed accessories,
visit us at:***

www.buylifetime.com

Or call:

1 (800) 424-3865

Congratulations on your Lifetime® Outdoor Shed purchase. By following the instructions below, your new Lifetime shed should provide you with years of service and enjoyment.

Cleaning and Care

The polyethylene walls and shelves are stain- and solvent resistant. To clean, use a mild soap and a soft-bristled brush. Abrasive cleaning materials may scratch the plastic and are not recommended. Repair scratches or rust spots on the metal by Sanding the affected area lightly; using a rust preventative spray primer; and finally, spraying with a high-gloss spray enamel paint. Avoid placing a direct heat source on or near surfaces unless using a heat barrier.

**For warranty details or to register your product, visit
www.lifetime.com or call 801-776-1532**