

## SOAP DISPENSING SYSTEM

### Mounting Instructions

1. Use **TAPE** with glazed tile, painted metal or unpainted metal walls. Tape will not perform satisfactorily if wall surface is porous like brick or wood.
2. Use **SCREWS** on all other walls as they provide the most positive long-lasting installation.
3. Thoroughly clean wall surface and let dry. For silicone build-up, use a pumice-type cleaner or grout cleaner to clean the surface.

**IMPORTANT:** After firmly placing backplate to wall surface, allow 24 hours curing time for proper adhesion before attaching tank to backplate.

4. Using tabs, snap lid free from tank.

**IMPORTANT:** Locate dispenser above a sink or counter. Recommend never locating where spillage can fall on floor creating hazardous condition. We cannot be held responsible for damage or injury due to improper installation.

### 1-2-3 Tape Method



1. clean the surface and let dry

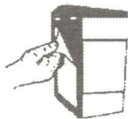

2. remove release paper



3. using the top as level, press firmly to wall/glass for 30 seconds

### A-B-C Screw Method

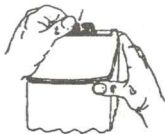

- A. remove lid, push latch out and lift dispenser from base plate



- B. drill holes for #8 x 7/8" self tapping wall screws and install them

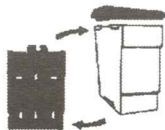

- C. replace so lower tab fits into base plate slot. Upper tabs slide down in slots and center latch catches

# SOAP DISPENSING SYSTEM

## Replacement Parts & Instructions

### Triad® Dispenser

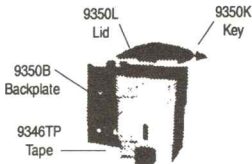

**Note:** Please specify color when ordering parts

### Triad®



9350 – 50 oz. bulk dispenses all soaps *except* grit



9350P – Push plunger for Triad® bulk dispenser

Replacement parts as shown above are available from your dispenser distributor. Screws are NOT furnished as each surface needs specific types.

**Keys for removing lid:** each dispenser will be furnished with two keys



1) For permanent installation when vandalism is NOT a problem. Insert key into hole on side of lid.



2) Second key, shown here and above, to be used when you want to remove key and store it in a safe area. Allen wrench or other sharp pointed instrument can be used for opening lid.

**Recommendation:** Clean surface thoroughly, use tile cleaner and other recommended cleaners for specific surfaces before installing back plate with tape.

**Removing Plunger:** Remove octagon nut from inside dispenser, then merely pull plunger out from front.

**Caution:** When installing backplate with tape, allow 24 hours before attaching the dispenser.

**Note:** When using viscous liquids hold finger over opening and pump 3-5 times to prime on bulk dispenser. It is recommended to prime pump with a small amount of soap prior to completely filling. Be sure pump is full of soap and dispensing soap properly before filling. Soap is necessary to lubricate pump.

### TRIAD® SOAP DISPENSER MAINTENANCE

- Using warm water mixed with soap from the dispenser is the best cleaning solution for all Triad® soap dispenser parts. Pump warm water through push plunger valve periodically to flush out any contaminants or dried soap residue.  
**NEVER USE ABRASIVE CLEANERS IN THE ENCORE® SOAP DISPENSER.**
- Periodically give the dispenser an overall cleaning. Remove the tank by separating it from backplate with the lid off.
- Do not disassemble the push plunger valve. NOTE: If for any reason the valve becomes non-fictional or the tank is damaged, a new complete Push Plunger valve (9350P) and Tank (9350T) assembly must be ordered.